



- ▲ Unique Curved Chain Discharge unit with side shift
- ▲ Discharge up to 1.26m / 50" high both left and right
- ▲ Flat Floor Feeding left and right
- ▲ Narrow machine width
- ▲ High Capacity discharge
- ▲ Consistent feed out
- ▲ Single and Twin auger machines from 8-24m<sup>3</sup> / 280-860 cu.ft.



# Why the Trioliet curved chain conveyor?



The new Trioliet curved chain conveyor allows the operator to feed off both the left and right side on the floor or into a trough without the width challenges of a flat or door mounted conveyor. The curved design of the VLC unit allows the discharge end of the conveyor to elevate when side shifted for easy trough feeding or discharging into a stationary conveyor. Standard flat conveyors only allow you to side shift and feed from one side. The VLC unit is streamlined, feeds from both sides and fits in those narrow feed alleys. Available from 8-24m<sup>3</sup> / 280-860 cubic foot, there is a VLC available whether you milk 50 cows or 1000.



Up to 35cm / 14" hydraulic side shift both left and right for 2,54m / 100" VLC unit.  
Heavy duty roller chain for long life.  
Direct hydraulic connection, Bowden Cable or Electric Operation.  
No feed loss on opposite side during discharge.

## Standard Features

Lowest HP per m<sup>3</sup> / cubic foot in the industry.  
Wide angle PTO shaft is standard.  
8mm / 5/16" side walls.  
1/2" wear ring on the bottom of the tub wall.  
2 restrictor blades.  
Trioform auger knives.

## Optional Equipment

Digi-Star Programmable Scales.  
Road lights for highway / public road use.  
20mm / 3/4" augers instead of standard 15mm / 5/8".  
Rubber or steel hay rings.  
540 or 1000 rpm drive on most models.  
Reduction gearboxes for easy loaded start-up.  
Rear pre-mix door.  
And other options available below that.



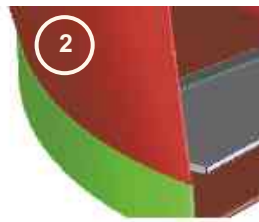
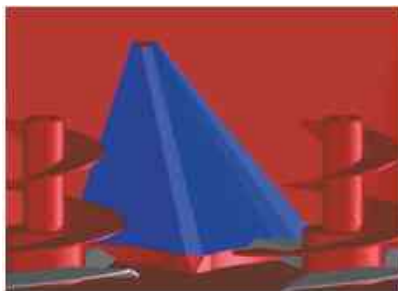

### 1. Horizontal Flow System (for mixer feeders with 2 or 3 augers only):

- Trioliet patented offset inserts, for true horizontal mixing and consistent and complete discharge.

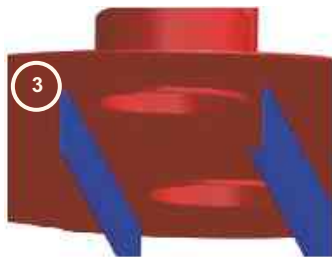

### 3. Chassis:

- Absorbs all the forces of the auger which are passed through by the auger column.
- Trioliet machines are standard equipped with a 3-point weighing system which is build stronger and has a lot of advantages against the conventional 4-point systems.

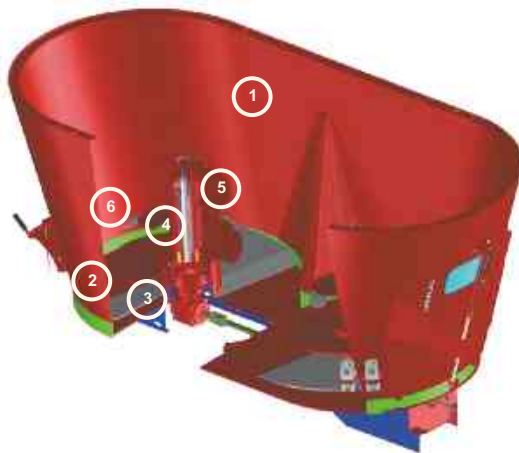

### 2. 1/2" Wear Ring:

- The special Trioliet wear ring ensures a long life of the mixing tub.



### 4. Auger Column and Bearing Construction:

- Large bearing distance (X) for maximum stability.
- Maintenance-free, conical roller bearing (4a) at the top of the auger for absorption of all axial auger forces, resulting in no axial forces on the planetary.
- Sinter sleeve bearing (4b) at the bottom of the auger, for absorption of large radial forces at the bottom of the auger.



### 5. Twin Stream auger:

- No wasted space and higher capacity of cubic foot because of slim auger body.
- Optimum and quick mixing process because of a wide and continuous auger flighting.
- Optimum auger flighting pitch for quick mixing and high filling rate.
- Optimum relation between the auger and mixing tub shape for a perfect, homogeneous mixing.
- Even and quick feed discharge caused by the two symmetrical dispenser arms.



### 6. Trioform Auger Knife:

- Shaped auger knife for:
  - Higher strength of construction (no support plate necessary).
  - Horizontal position (parallel to the mixing tub bottom) on the auger flighting for optimum cutting performance.
- Less resistance in the feed, less power required (fuel saving).
- Self-sharpening.
- Long life.
- Patent pending.

Model Single Auger	800 VLC	1000 VLC	1000 L VLC	1200 VLC	1400 VLC
Discharge	Curved cross chain conveyor at front				
Capacity m <sup>3</sup> /Cu. Ft.	8/280	10/350	10/350	12/430	14/500
Overall length m/Inch	4.82/190"	4.90/193"	5.02/198"	4.92/194"	5.20/205"
Overall width m/Inch	2.30/91"	2.30/91"	2.54/100"	2.45/96"	2.54/100"
Overall height m/Inch	2.48/98"	2.77/109"	2.48/98"	2.94/116"	3.01/119"
Track width m/Inch	1.91/75"	1.91/75"	2.11/83"	1.91/75"	2.11/83"
Length cross conveyor m/Inch	2.30/90"	2.30/90"	2.54/100"	2.30/90"	2.54/100"
Discharge height (central position) m/Inch*	1.00/39"	1.00/39"	1.07/42"	1.00/39"	1.07/42"
Discharge height (side shifted) m/Inch*	1.22/48"	1.22/48"	1.31/52"	1.22/48"	1.31/52"
Height bottom of conveyor (central position) m/Inch	0.82/32"	0.82/32"	0.89/35"	0.82/32"	0.89/35"
Height bottom of conveyor (side shifted) m/Inch	1.04/41"	1.04/41"	1.13/44"	1.04/41"	1.13/44"
Width of cross conveyor belt m/Inch	0.75/30"	0.75/30"	0.75/30"	0.75/30"	0.75/30"
Net weight kg/Lbs	3.540/7,800	3.740/8,250	4.030/8,880	4.050/8,930	4.540/10,010
Number of auger knives	5	6	6	7	9
Power requirement PTO HP (kW)	66 (48)	68 (50)	75 (55)	75 (55)	82 (60)
Wheels (2 x)	400/45 L 17.5				

\* Top side of chain

Model Twin Augers	1200 VLC H	1500 VLC H	1600 VLC H	1800 VLC H	2000 VLC H
Discharge	Curved cross chain conveyor at front				
Capacity m <sup>3</sup> /Cu. Ft.	12/430	15/540	16/570	18/650	20/715
Overall length m/Inch	6.19/244"	6.56/260"	6.60/260"	7.08/279"	7.14/281"
Overall width m/Inch	2.30/85"	2.30/90"	2.30/90"	2.30/90"	2.30/90"
Overall height m/Inch	2.50/98"	2.63/104"	2.76/109"	2.83/111"	3.01/119"
Track width m/Inch	1.71/67"	1.91/75"	1.91/75"	2.15/85"	2.15/85"
Length cross conveyor m/Inch	2.30/90"	2.30/90"	2.30/90"	2.30/90"	2.30/90"
Discharge height (central position) m/Inch*	1.00/39"	1.00/39"	1.00/39"	1.13/44"	1.13/44"
Discharge height (side shifted) m/Inch*	1.22/48"	1.22/48"	1.22/48"	1.35/53"	1.35/53"
Height bottom of conveyor (central position) m/Inch	0.82/32"	0.82/32"	0.82/32"	0.95/37"	0.95/37"
Height bottom of conveyor (side shifted) m/Inch	1.04/41"	1.04/41"	1.04/41"	1.17/46"	1.17/46"
Width of cross conveyor belt m/Inch	0.75/30"	0.75/30"	0.75/30"	0.75/30"	0.75/30"
Net weight kg/Lbs	5.000/11,020	5.600/12,570	5.700/12,570	6.200/13,670	6.900/15,210
Number of auger knives	4	5	5	5	5
Power requirement PTO HP (kW)	62 (60)	85 (62)	85 (62)	102 (75)	102 (75)
Wheels (2 x)	400/45 L 17.5				

\* Top side of chain

### Single axle

### Tandem axles

Model Twin Augers	2000 L VLC H	2400 L VLC H	2000 VLC H T	2400 VLC H T
Discharge	Curved cross chain conveyor at front			
Capacity m <sup>3</sup> /Cu. Ft.	20/715	24/860	20/715	24/860
Overall length m/Inch	7.50/295"	7.57/298"	7.13/281"	7.20/283"
Overall width m/Inch	2.54/100"	2.66/105"	2.30/90"	2.44/96"
Overall height m/Inch	2.66/105"	2.97/117"	3.04/120"	3.25/128"
Track width m/Inch	2.15/85"	2.15/85"	1.87/74"	1.87/74"
Length cross chain conveyor m/Inch	2.54/100"	2.54/100"	2.30/90"	2.30/90"
Discharge height (central position) m/Inch*	1.20/47"	1.20/47"	1.16/46"	1.16/46"
Discharge height (side shifted) m/Inch*	1.44/57"	1.44/57"	1.38/54"	1.38/54"
Height bottom of conveyor (central position) m/Inch	1.02/40"	1.02/40"	0.98/39"	0.98/39"
Height bottom of conveyor (side shifted) m/Inch	1.26/50"	1.26/50"	1.20/47"	1.20/47"
Width of cross chain conveyor m/Inch	0.75/30"	0.75/30"	0.75/30"	0.75/30"
Net weight kg/Lbs	6.900/15,210	8.400/18,520	7.200/15,870	7.700/16,980
Number of auger knives	5	6	5	7
Power requirement PTO HP (kW)	112 (82)	120 (88)	102 (75)	109 (80)
Wheels	435/50 R 19.5 (2 x)		305/70 R 19.5 (4 x)	

\* Top of chain



**TRIOLIET MULLOS B.V.**

Hinmanweg 19  
NL-7575 BE Oldenzaal  
The Netherlands

**Tel.** +31 541 57 21 21

**Fax** +31 541 57 21 25

**E-mail** info@trioliet.com

**www.trioliet.com**



*Trioliet: Invents for you.*